

Butterfly

Versatile and unique folder for full dry towels, fitted sheets, blankets and light uniforms



High production by the renowned Butterfly folder

Building on the DNA of the renowned JENSEN towel folders, the new Butterfly series carries on a long tradition with experience from thousands of folders delivered worldwide. The experience and know-how from the vast number of folders guarantees optimum production every day.



Increased flexibility by the new DeltaFlex cross fold

Thanks to a new DeltaFlex cross fold section, the Butterfly folder model "Blade" handles the complete range of towels with fewer moving parts in the cross fold section. An optional cross fold section on the model for light uniforms allows folding of light uniforms as well as towels for laundries requiring full flexibility.

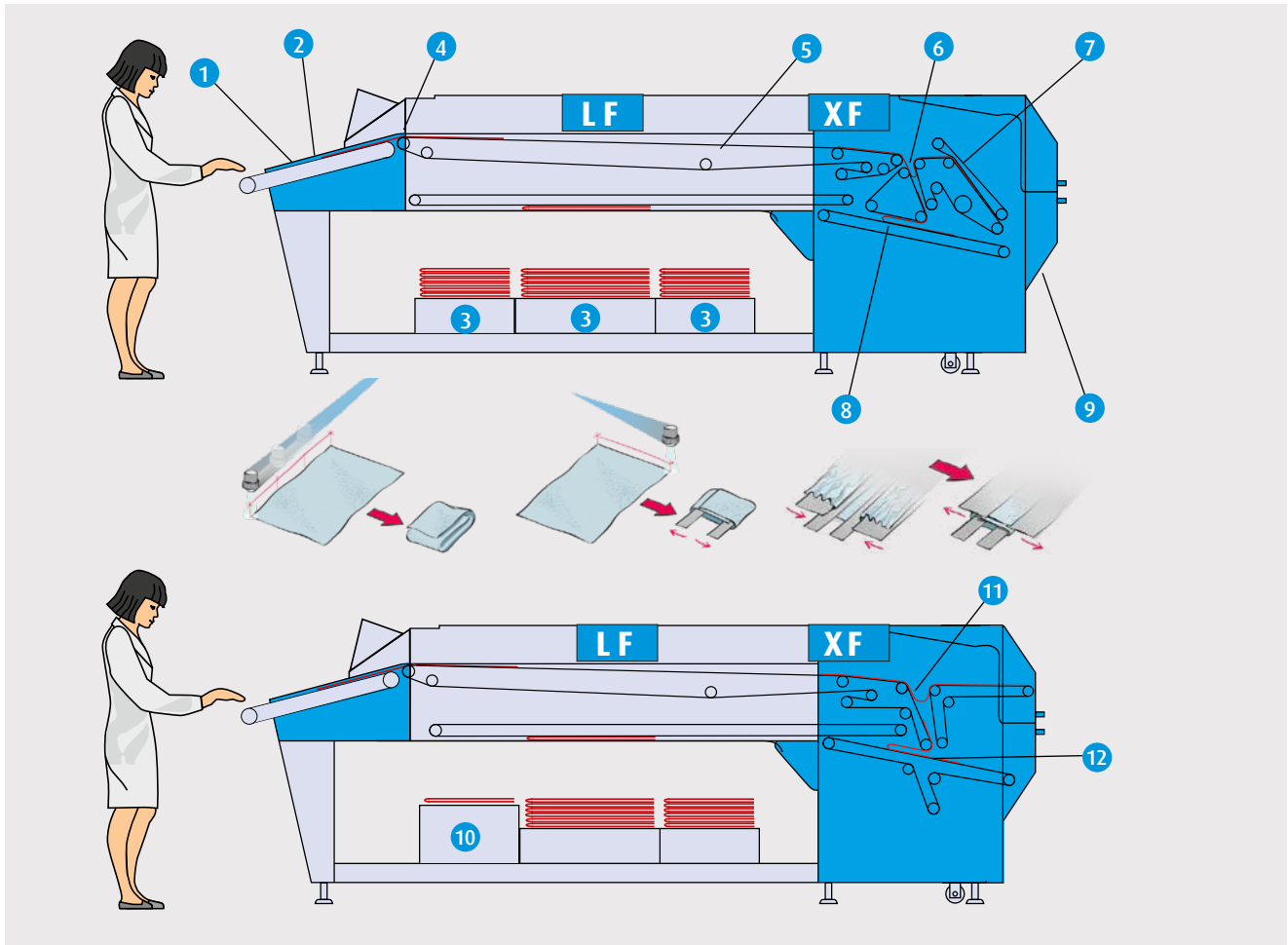

Optimum production

1 Fast feeding

The Butterfly folder is available with a number of options depending on model and type of products processed. Optional height adjustable inlet table and vacuum support at the inlet table is recommended when feeding large towels or light uniforms ensuring optimum ergonomic working conditions.

2 Automatic sorting and stacking

Three photocells placed on the feeding table enable automatic sorting and stacing onto pre-determined stackers **3** according to item width or feeding position.

As an optional feature three vertically and three horizontally positioned photocells placed on the inlet table can be combined, providing in total six photocells allowing automatic setting of the folding parameters, and automatic sorting and stacking according to program. Bypass of up to 600 mm (23.6") wide pieces for cross folding or stacking only is possible.

Increased automation

4 Optimum PPOH by AutoSelect

The AutoSelect program works by means of a photocell positioned between the inlet and the lateral folding section.

The AutoSelect program considerably increases the PPOH in mixed production, as the machine automatically measures the length of the item during feeding. Based on the length of the item, the machine automatically selects the right folding program and stacks the piece on a pre-determined stacker.

Depending on choice of options, the Butterfly folder can handle towels with a minimum size of L. 420 × W. 400 mm (16.5" × 15.7") and a maximum width of 1200 mm (47"). The maximum towel length is 2000 mm (79").

As an option, the Butterfly can handle towels with a length of up to 2400 mm (94"). If supplied with the optional pre-fold **13** the Butterfly folder can handle large spa towels or blankets with a length of up to 3200 mm (126") as well.

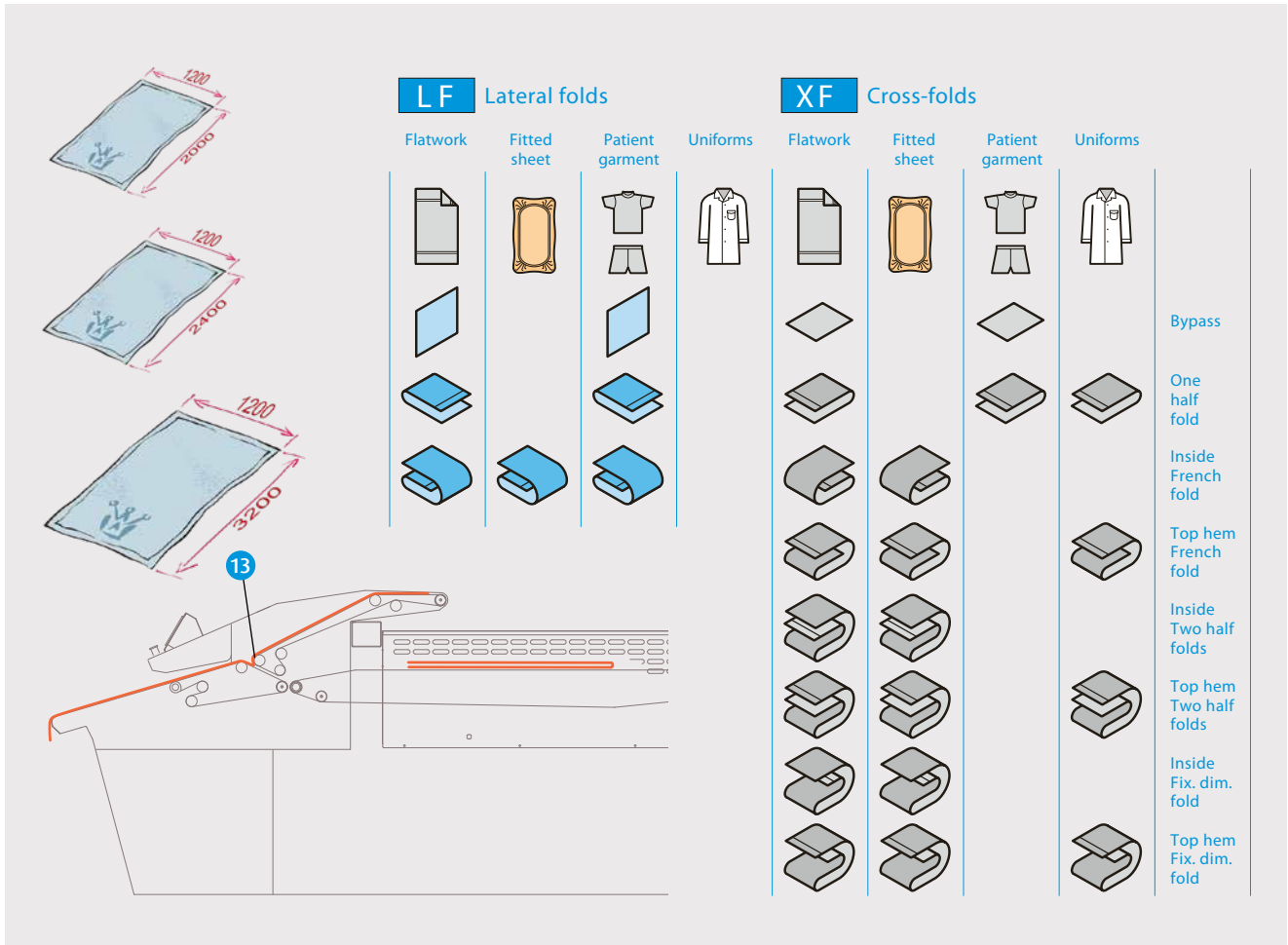

Top-quality folding

5 Excellent folding by blades

The lateral fold is performed by folding blades (5) folding the piece across the adjustable template. The horizontal folding movement guarantees fast folding, while the folding blades provide a stretching effect to the linen, which is particularly beneficial for light uniforms and fitted sheets. On folding light uniforms, the sleeves are manually folded in before feeding. Thanks to the use of mechanical folding blades instead of air blast, the consumption of compressed air is considerably reduced.

6 Flexible cross fold by "DeltaFlex"

The first cross fold in the DeltaFlex cross fold section is performed by reversing conveyors and air blast ensuring optimum control and folding quality. Thanks to the DeltaFlex cross fold section using wide flexible belts, it automatically adapts to the thickness of the item.

7 Optimum grip by a reversing conveyor

A reversing conveyor positioned after the 1st cross fold opening ensures optimum grip and full control of the item, resulting in an exact fold.

Full control

8 Versatile cross folding

The second cross fold is performed by reversing conveyors and a Delta conveyor. Thanks to the combination, the item is pressed between belts ensuring optimum friction and control of the item during folding. Depending on the folding combination, it performs one or two cross folds as half folds, or one French fold.

9 Reject possible

If pressing the reject button at the feeding table, the piece will be rejected after the lateral folding, reducing the risk of a jam in the cross fold section.

10 Lift stacker

Each stacker is available with an optional lifting device. The lifting device lifts the stacker to a receiving height close to the stacking flaps giving a better stacking quality as a result.

11 12 Light uniforms possible

The Butterfly model for light uniforms comprises an optional "rocking conveyor" at the first cross fold which automatically adapts according to type of product allowing cross folding of light uniforms, trousers and T-shirts as well as towels.

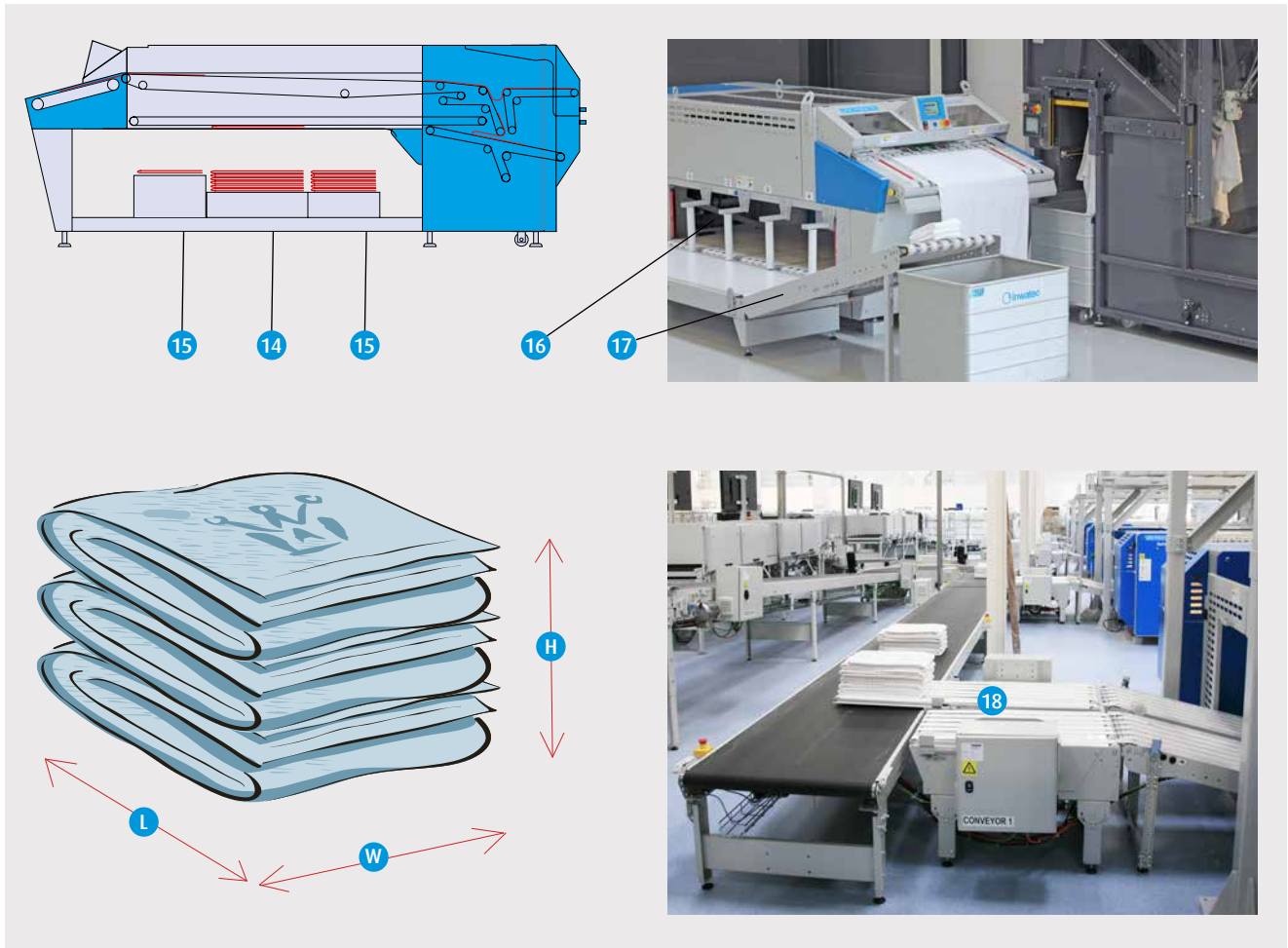

Stacking solutions

14 15 Stacking section

The stacking section provides up to four stackers with a length **L** of 470 mm (18.5"). The most sold model comprises two roll-off stackers **15** of **L** 470 mm (18.5"), with an optional stacker **14** of **L** 670 mm (26.3") positioned in the middle. Coupling of stackers is possible allowing larger pieces to be stacked.

Stacking size and position

Each stacker is designed for a stacking size of: L. 470 × W. 475 × H. 300 mm (L. 18.5" × W. 18.7" × H. 11.8"). Optional larger stacking is possible allowing to increase the length and width of the stacked items by 200 mm (7.8"), and the stacking height by 100 mm (3.9").

Delivery solution

16 Simplified reject conveyor

The majority of Butterfly folders are supplied with roll-off conveyors positioned after the stacker. The folder is also available with a simplified reject conveyor developed for the high-speed package.

17 Return to operator

Return to the operator includes a roll-off conveyor delivering the stack to an inclined conveyor positioned at the side of the machine.

18 Delivery to a Jenway system

The inclined transport conveyor can be connected to a Jenway conveyor system via an optional roll-off table enabling automatic transportation of the stack to a central delivery point.

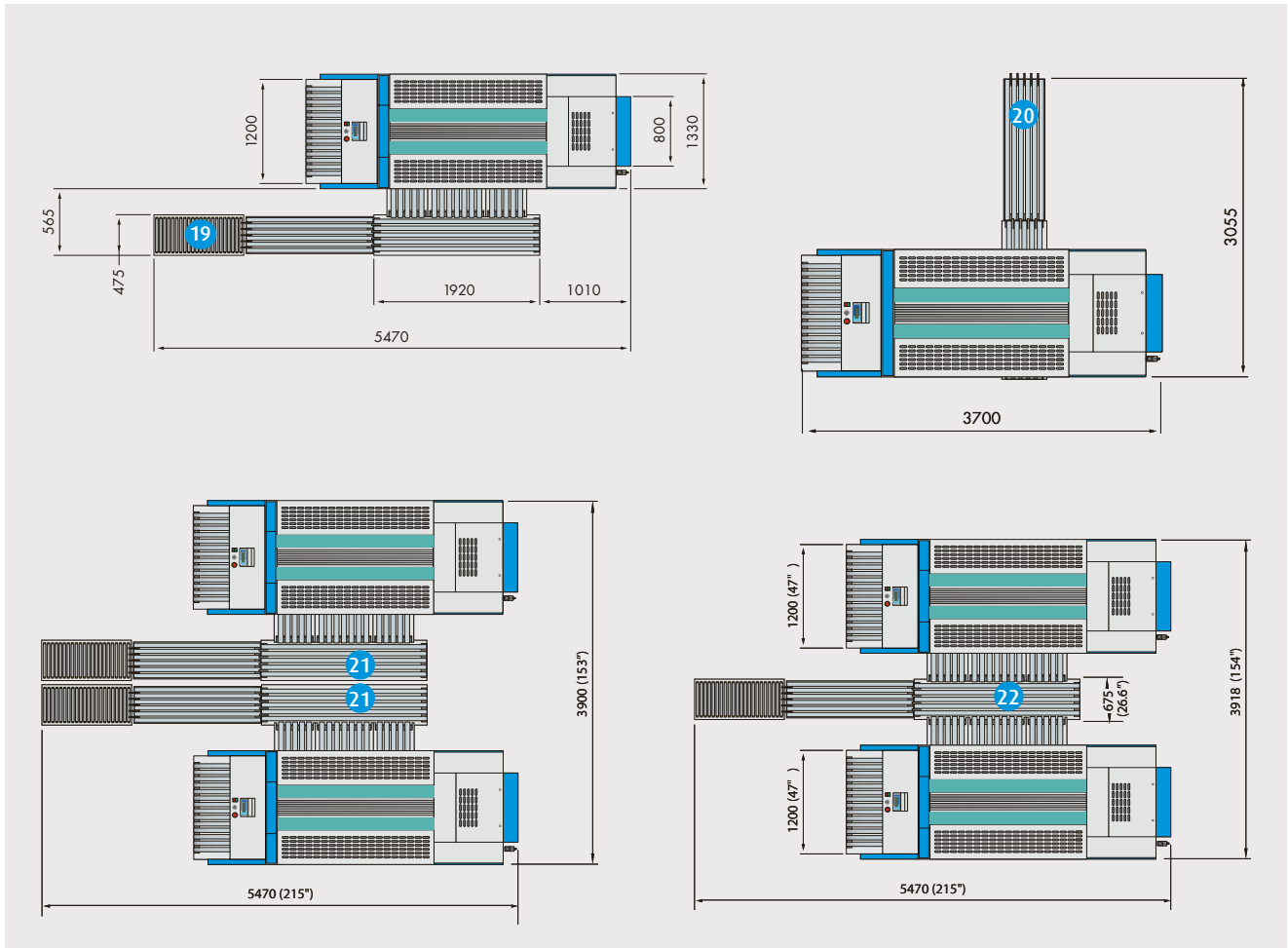

High capacity

Faster than an operator

The Butterfly folders ensure the optimum stacking quality thanks to the roll-off conveyors delivering the stacks gently onto the delivery conveyor. In this configuration, the Butterfly folder has a cycle time of 2.25 seconds allowing a theoretical maximum capacity of up to 1600 pcs/hr. without sorting, and up to 1200 pcs/hr. when sorting three mixed sizes of towels on three stackers by use of the AutoSelect program.

Increased capacity

As an option, the Butterfly model "Blade" is available with a high-speed package incorporating a simple and fast stacking conveyor. As a result, the cycle time of the machine will be reduced to 1.8 seconds when folding small or medium size towels without sorting.

Layout examples

19 Outlet with return to operator

The stack will stop on the delivery conveyor or on an optional roller conveyor positioned close to the operator.

20 Outlet to an incline conveyor

This solution eliminates the need for a Roll-Off conveyor as the stack will be dropped directly onto the delivery conveyor.

21 Twin solution

The Twin solution comprises two separate Butterfly folders equipped with their own delivery conveyors placed in a mirror configuration to save space. Thanks to the two individual machines, this solution is faster and cheaper than the Master/Slave solution.

22 Master/Slave solution

The Master/Slave solution comprises two Butterfly folders sharing one delivery conveyor to save space.



23 iJOS – the new intuitive JENSEN operating System

iJOS features a fast and accurate processor, an easy-to-use human-machine interface with icon-driven navigation, multi-language facilities and an option for remote system service.

- Icon-driven navigation with consistent visual language.
- Easy installation and task selection of towel type, fold type, sorting and stacker number via tappable modules and pictograms.
- Easy configuring of towel folding and sorting by selecting intuitive icons, ideal for operators with minimal training as the system guides the user.

24 Optimized production by the Thor separator

To optimize the utilization of the Butterfly folder, the “THOR” separator has been developed.

The THOR separator continuously supplies towels at an ergonomic height, significantly increasing operator productivity.

Installation

JENSEN is pleased to assist you in planning your laundry by providing excellent advice, layouts and technical data. Authorised JENSEN distributors or JENSEN engineers should carry out the installation to ensure that it is performed correctly.

Service

In addition, JENSEN provides an extraordinary after sales service through a worldwide network of highly qualified Sales and Service Centers and distributors, all with their own maintenance and spare parts services.

Call us...

JENSEN provides a complete range of heavyduty equipment for the laundry industry, delivered and installed according to your specifications. Please do not hesitate to contact us for further advice and information, or visit

www.jensen-group.com

Local contact



www.jensen-group.com



Explore our equipment on  **YouTube**
www.youtube.com/jensengroupcom